

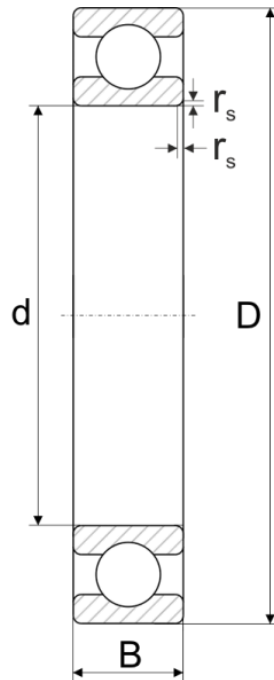

# 스테인레스 볼 베어링 (S618, S619)

Stainless steel thin section ball bearing



## 스테인레스 볼 베어링 (S618, S619)

SWC는 스테인레스 볼 베어링과 함께 보다 얇은 제품군인 스테인레스 618, 619 시리즈도 공급해 드리고 있습니다. 제공되는 타입은 아래의 두 가지 타입으로 공급됩니다.

- T280: H1 인증(식음료 안전등급) 윤활제 (280°C)
- T320: H1 인증(식음료 안전등급) 윤활제 (320°C)

사용온도 범위에 관계없이 제공되는 모든 SWC 스테인레스 볼 베어링에는 아래의 특성을 포함합니다.

- 스테인레스 스틸 재질의 일반 열처리
- C3 틈새
- 리벳 스틸 케이지
- 스틸 실드 (2ZR)



## SWC Stainless Steel Thin Section Ball Bearings

In line with the Stainless Steel Deep Groove Ball Bearings, SWC also offers Thin Section Ball Bearings made of stainless steel, which come in two different versions:

- T280  
including high-quality food-grade lubricant (suitable up to 280°C) with H1 certificate
- T320  
including high-quality food-grade lubricant (suitable up to 320°C) with H1 certificate

Regardless of the lubricant, all stainless steel bearings comprise the following properties:

- General heat treatment of the stainless steel bearing
- Radial clearance C3
- Riveted sheet steel cage
- Steel shields (2ZR)

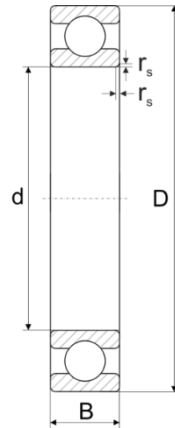

## S618xx

Bezeichnung Code	Dimensionen Dimensions				Tragzahlen Load Ratings		Max. Drehzahl Max. Speed			Gewicht Weight
	d	D	B	$r_s$ min	$C_0$	$C_{dyn}$	Open	T280	T320	
SWC	[mm]	[mm]	[mm]	[mm]	[kN]	[kN]	[min <sup>-1</sup> ]	[min <sup>-1</sup> ]	[min <sup>-1</sup> ]	≈ [kg]
<b>S61800</b>	10	19	5	0.3	0.75	1.59	32,000	16,667	16,667	0.005
S61801	12	21	5	0.3	1.04	1.91	29,000	15,000	15,000	0.006
S61802	15	24	5	0.3	1.25	2.07	27,000	12,766	12,766	0.007
S61803	17	26	5	0.3	1.36	2.13	25,000	11,538	11,538	0.020
S61804	20	32	7	0.3	2.23	3.48	22,000	9,677	9,677	0.022
S61805	25	37	7	0.3	2.63	3.68	18,000	8,333	8,333	0.026
S61806	30	42	7	0.3	3.15	4.00	15,000	7,059	7,059	0.027
S61807	35	47	7	0.3	3.60	4.27	13,000	6,186	6,186	0.030
S61808	40	52	7	0.3	3.89	4.41	12,000	5,556	5,556	0.030
S61809	45	58	7	0.3	4.33	4.59	11,000	5,000	5,000	0.044
S61810	50	65	7	0.3	6.08	6.61	9,000	4,615	4,615	0.049
S61811	55	72	7	0.3	8.08	8.53	8,500	4,138	4,138	0.084
S61812	60	78	9	0.3	8.76	9.20	7,600	3,871	3,871	0.106

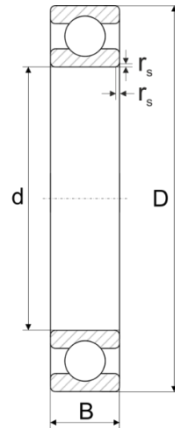

## S619xx

Bezeichnung Code	Dimensionen Dimensions				Tragzahlen Load Ratings		Max. Drehzahl Max. Speed			Gewicht Weight
	d	D	B	$r_s$ min	$C_0$	$C_{dyn}$	Open	T280	T320	
SWC	[mm]	[mm]	[mm]	[mm]	[kN]	[kN]	[min <sup>-1</sup> ]	[min <sup>-1</sup> ]	[min <sup>-1</sup> ]	≈ [kg]
<b>S61900</b>	10	22	6	0.3	1.27	2.69	29,000	15,000	15,000	0.008
S61901	12	24	6	0.3	1.46	2.89	25,000	13,636	13,636	0.011
S61902	15	28	7	0.3	2.25	4.32	23,000	12,000	12,000	0.016
S61903	17	30	7	0.3	2.55	4.59	22,000	10,526	10,526	0.018
S61904	20	37	9	0.3	3.68	6.37	20,000	8,955	8,955	0.036
S61905	25	42	9	0.3	4.18	6.66	16,000	7,792	7,792	0.042
S61906	30	47	9	0.3	5.01	7.24	14,000	6,522	6,522	0.048
S61907	35	55	10	0.6	7.16	10.39	12,000	5,607	5,607	0.074
S61908	40	62	12	0.6	9.20	13.02	11,000	5,000	5,000	0.112
S61909	45	68	12	0.6	10.13	13.49	9,900	4,615	4,615	0.128
S61910	50	72	12	0.6	10.66	13.90	9,000	4,286	4,286	0.132
S61911	55	80	13	1.0	12.69	14.82	8,500	3,871	3,871	0.180
S61912	60	85	13	1.0	13.48	15.08	8,100	3,529	3,529	0.198